

of

recorded July 13, 2023 as Document Number 1081332 and located in the Southwest 1/4 of the Northwest 1/4 and the Northwest 1/4 of the Southwest 1/4 of Section 34, Town 2 North, Range 15 East, Town of Darien, Walworth County, Wisconsin.

Bearings referenced to the West line of the Northwest 1/4 of Section 34-2-15, recorded as N1°02'13"W in the Wisconsin State Plane Coordinate System, South Zone, (NAD-27).

Tax Parcel
BD 3400009

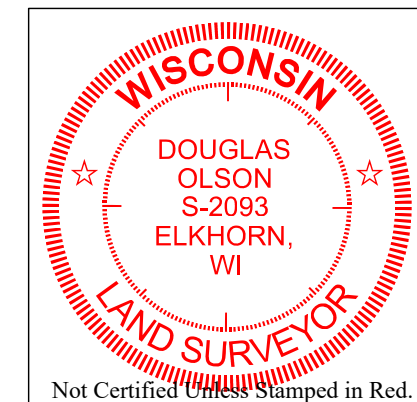

- 1) This Plat of Survey is not certified unless signed and sealed in red ink.
- 2) This survey is subject to Wisconsin lien laws. This Plat of Survey is the notice of intent to file lien. Lien waiver required.
- 3) The Survey Date shown on this Plat of Survey is the completion date of the field work.

All rights reserved. No part of this survey plat may be reproduced or transmitted in any form by any means - graphic, electronic, or mechanical, including photocopying, tracing, or information storage and retrieval systems - without permission in writing from Douglas G. Olson, Olson Land Surveying, LLC.

This survey is made for the exclusive use of the present owners of the property, and also those who purchase, mortgage or guarantee title thereto, within one year from the date hereof.

Revisions: No. 1 - Recorded CSM

Elkhorn, Wisconsin. 53121
Telephone: (262) 723-3434
Facsimile: (262) 723-8044
Email: doug@olsonsurveying.com
Website: www.olsonsurveying.com

OLSON

LAND SURVEYING, LLC

Rural | Residential | Commercial

Found County Section Corner
 Found Iron Rod
 Set Iron Pipe, 1" dia.
 Recorded Information
 Utility Pole
 Utility Pedestal
 Concrete Cover
 Asphalt Surface
 Concrete Surface
 Gravel Surface
 Concrete Surface
 Gravel Surface

Job Reference Number
2023.021

2023.021